

# MODEL CBEX ELITE

## 1300 - 2200 HP



### *Dimensions and Ratings*

**Table 1. CBEX Elite Steam Boiler Ratings 1300-2200 HP**

Boiler H.P.	1300	1400	1500	1600	1800	2000	2200	
<b>Ratings</b>								
Rated Capacity - Steam (lbs-steam/hr from & at 212°F)	44,850	48,300	51,750	55,200	62,100	69,000	75,900	
Output (1000 Btu/hr)	43,518	46,865	50,213	53,560	60,255	66,950	73,645	
Fireside Heating Surface (sq.ft.)	3528	4069	4212	4646	5382	5711	6640	
<b>Approximate Fuel Consumption At Rated Capacity</b>								
Light Oil Input (gph) - 150# Steam <sup>C</sup>	383.8	413.3	442.8	472.3	531.3	590.4	649.4	
Natural Gas Input (cfh) - 150# Steam <sup>A</sup>	53,725	57,858	61,991	66,123	74,389	82,654	90,920	
<b>Power Requirements - 60Hz, 3-Phase</b>								
Blower Motor Size (HP) <sup>B</sup>	Uncontrolled NO <sub>x</sub>	60	75	75	75	75	100	100
	30 ppm	75	100	125	100	100	125	125
	9 ppm	100	100	125	150	150	200	200
Oil Pump Motor HP (#2 Oil)	2	2	2	2	3	3	3	
Air Compressor Motor HP (#2 Oil)	15	15	15	-	-	-	-	
<p>Notes:</p> <p>A. Input calculated at nominal 81% efficiency for 1000 Btu gas content</p> <p>B. For altitudes above 700 ft, contact local Cleaver Brooks authorized representative for verification of boiler and blower motor size.</p> <p>C. Input calculated at nominal 81% efficiency based on 140,000 Btu/gal</p>								

Table 2. Dimensions CBEX Elite 1300-1500 HP

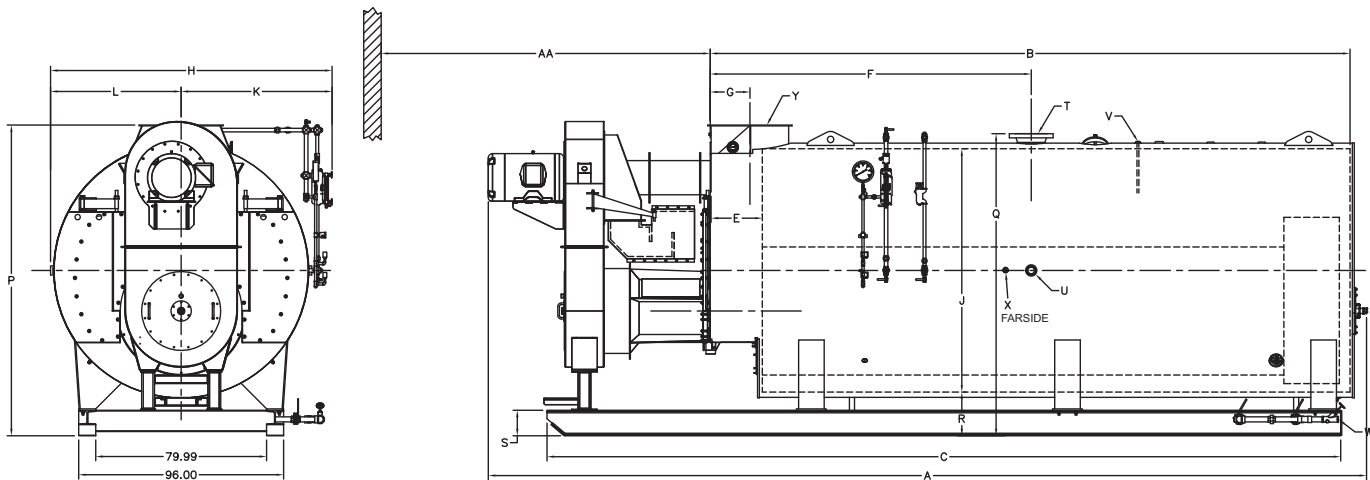

Boiler Horsepower	Dim.	1300	1400	1500
Lengths				
Overall	A	385	404	413
Shell	B	281	300	309
Base Frame	C	353	372	381
Over Tubesheets	D	256	275	384
Shell Extension	E	24	24	24
Front To Steam Nozzle	F	142	150	162
Front To Vent Outlet	G	18-1/2	18-1/2	18-1/2
Widths				
Overall	H	131	131	131
Boiler I.D.	J	114	114	114
Center To Water Column	K	71	71	71
Center To Lagging	L	60	60	60
Base Inside	M	80	80	80
Base Outside	N	96	96	96
Hights				
Base To Vent Outlet	P	145-1/2	145-1/2	145-1/2
Base To Steam Outlet	Q	141-1/2	141-1/2	141-1/2
Base To Boiler Bottom	R	20	20	20
Base Rail	S	12	12	12
Connection Sizes				
Steam Nozzle (150 PSIG)	T	10	12	12
Steam Nozzle (200 PSIG)	T			
Feed Water	U	3	3	3
Surface Blowoff	V	1	1	1
Blow Down	W	2	2	2
Chemical Feed	X	3/4	3/4	3/4
Vent Stack Outlet	Y	36	36	36
Minimum Clearances				
Tube Removal (Front Only)	AA	203	222	231
Weight In Lbs.				
Normal Water Capacity		41,320	43,829	45,392
Approx. Ship Weight (150 PSIG)		65,424	69,672	71,435
Approx. Ship Weight (200 PSIG)		72,087	76,810	78,799

Table 3. Dimensions CBEX Elite 1600-2200 HP

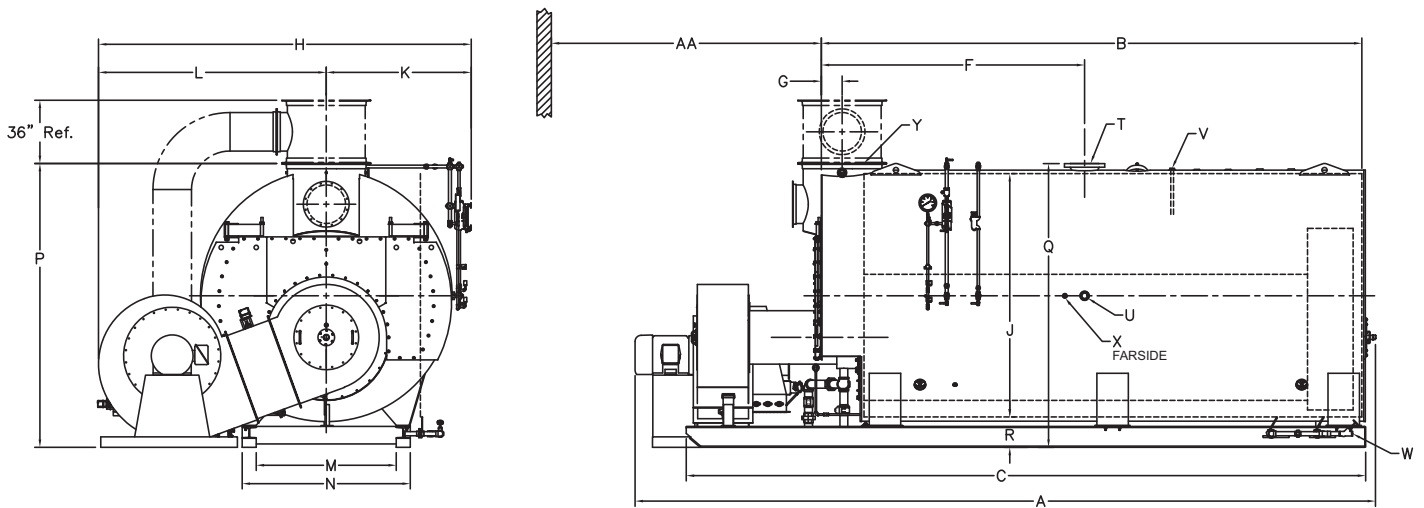

Boiler Horsepower	Dim.	1600	1800	2000	2200
Lengths					
Overall	A	410	424	410	424
Shell	B	296	310	296	310
Base Frame	C	374	388	374	388
Over Tubesheets	D	270	284	270	284
Shell Extension	E	24	24	24	24
Front To Steam Nozzle	F	142	150	142	150
Front To Vent Outlet	G	21-1/4	21-1/4	11-7/8	11-7/8
Widths					
Overall	H	207	207	213	213
Boiler I.D.	J	126	126	138	138
Center To Water Column	K	77	77	83	83
Center To Lagging	L	130	130	130	130
Base Inside	M	80	80	80	80
Base Outside	N	96	96	96	96
Hights					
Base To Vent Outlet	P	158	158	162	162
Base To Steam Outlet	Q	153-5/8	153-5/8	162	162
Base To Boiler Bottom	R	20	20	17-1/2	17-1/2
Base Rail	S	12	12	12	12
Connection Sizes					
Steam Nozzle (150 PSIG)	T	12	12	14	14
Steam Nozzle (200 PSIG)	T				
Feed Water	U	3	3	3	3
Surface Blowoff	V	1	1	1	1
Blow Down	W	2	2	2	2
Chemical Feed	X	3/4	3/4	3/4	3/4
Vent Stack Outlet	Y	42	42	44	44
Minimum Clearances					
Tube Removal (Front Only)	AA	216	230	216	230
Weight In Lbs.					
Normal Water Capacity		52,311	53,797	63,095	63,687
Approx. Ship Weight (150 PSIG)		78,667	83,445	92,706	99,133
Approx. Ship Weight (200 PSIG)		90,060	95,387	104,988	112,016

# Notes



e-mail: [info@cleaverbrooks.com](mailto:info@cleaverbrooks.com)  
Web address: <http://www.cleaverbrooks.com>